

ONE VALLEY  
San Mateo, CA

# 2955 Campus Drive

Turn Key Offices &  
Coworking Space

COVID SAFE SPACE  
designed for  
productivity

14,000 sqft  
AVAILABLE



**Johan Quie** | Vice President  
(415) 349-7738 | [johaneipgsf.com](mailto:johaneipgsf.com)  
BRE 01948103

**Ivan Smiljanic** | Partner  
(510) 717-5008 | [ivan@ipgsf.com](mailto:ivan@ipgsf.com)  
BRE 01995999

**Sarina El** | Innovation Center Manager  
(510) 650-6611 | [sarina@theonevalley.com](mailto:sarina@theonevalley.com)  
[theOneValley.com](http://theOneValley.com)





Located right off of highway 80 and the 101 freeway, you'll find our captivating creative work space that offers flexibility and an amenity rich experience built for any size company, whether you're a founder with a billion dollar idea or an enterprise company looking to host your innovation team in the heart of Silicon Valley!

We have meticulously planned and built out our two level flexible office space with over 14,000 square feet of open space, 12 meeting rooms of varying sizes, window lined offices designed for single and team use, dedicated desk and hot desk users. This is the \*perfect\* location if you have a dispersed team, as we're centrally located in San Mateo right off the highway with PLENTY of FREE parking, and ease of access with Cal-Train Shuttle services.



## Included with every membership

Supporting Startups Where and When it Matters Most. Passport is the world's most comprehensive digital innovation platform, connecting entrepreneurs and emerging startups with access to vital resources, networks, and significant savings on essential business tools. Save on essential tools and services valued at over \$1M, across cloud computing, video conferencing, payments, CRM, sales tools, and much more. Connect with thousands of like-minded founders supporting one another through shared experiences, advice, and networking.



**Sarina El** | Innovation Center Manager  
(510) 650-6611 | [sarina@theonevalley.com](mailto:sarina@theonevalley.com)  
[theOneValley.com](http://theOneValley.com)

**Innovation Properties Group**  
181 2nd Street, San Francisco, CA  
[www.ipgsf.com](http://www.ipgsf.com) | CL 02031924

**Johan Quie** | Vice President  
(415) 349-7738 | [johan@ipgsf.com](mailto:johan@ipgsf.com)  
BRE 01948103

**Ivan Smiljanic** | Partner  
(510) 717-5008 | [ivan@ipgsf.com](mailto:ivan@ipgsf.com)  
BRE 01995999

- Access to Passport by OneValley, a perks program valued at over \$1M in savings + access to top advisors and investors
- Ample, FREE parking access
- 12 sanitation stations located in building
- Gym membership included
- Fast & secure WiFi
- Private offices, dedicated desks, & hot desks available
- Standing desks and upscale furniture to choose from
- 24/7 access to workspace
- Modern kitchen & cafe lounge
- Complimentary flavored parking & filtered water
- Complimentary Coffee & Tea Service
- Organic, gourmet meals via Byte vending machine
- Unlimited color printing & scans
- Professional shredding service
- Premium Silicon Valley address
- Outdoor Patio Area
- 12 conference rooms available to book
- Booking credits available per membership type
- Screen casting available via monitors & projectors
- Poly-Com phones in all conference rooms and phone booths
- (8) Phone booths
- Lower capacity conference rooms and sanitation stations inside or nearby
- Robust COVID protocols in place to ensure safety and sanitation
- Health survey and temperature check in upon entry
- 12 sanitation stations located in Building
- Masks required in common areas
- Operating at 50% max capacity to allow for safe, social distancing
- Flow of traffic directions within innovation center
- Lower occupancy in common areas and conference rooms

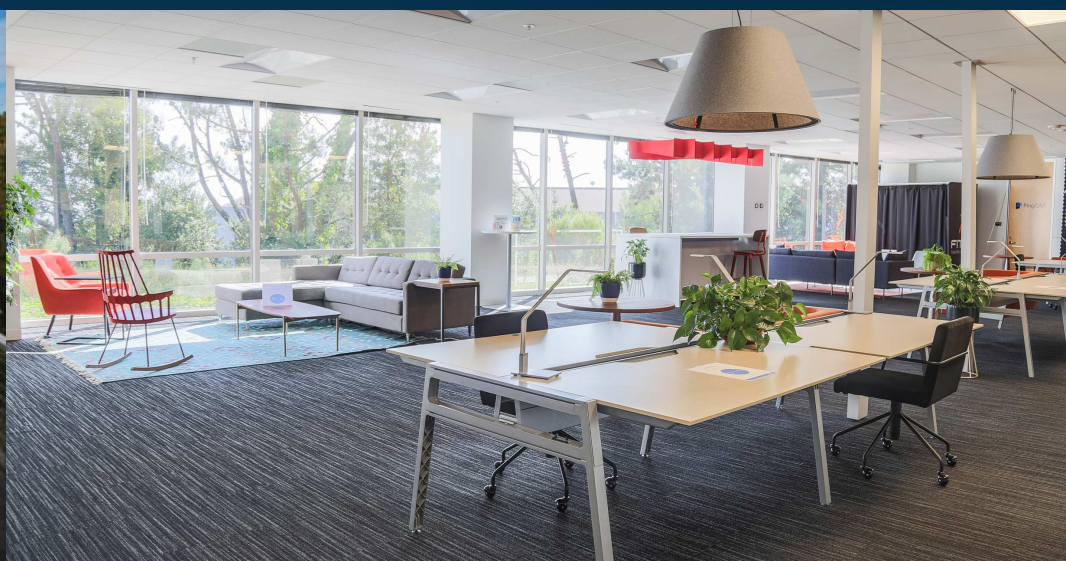











## Suite 110

## Legend

- # Free seats
- Available Office Space
- Available Hot Desks





## Suite 300

## Legend

# Free seats

Available Office Space

Available Dedicated Desks

**Innovation Properties Group**

181 2nd Street, San Francisco, CA

[www.ipgsf.com](http://www.ipgsf.com) | CL 02031924**Johan Quie** | Vice President(415) 349-7738 | [johan@ipgsf.com](mailto:johan@ipgsf.com)

BRE 01948103

**Ivan Smiljanic** | Partner(510) 717-5008 | [ivaneipgsf.com](mailto:ivaneipgsf.com)

BRE 01995999

**Sarina El** | Innovation Center Manager(510) 650-6611 | [sarina@theonevalley.com](mailto:sarina@theonevalley.com)[theOneValley.com](http://theOneValley.com)





### Restaurants & Bars

- 1 Celia's
- 2 Jamba Juice
- 3 Mc Donald's
- 4 Shiki Japanese Restaurant
- 5 Sonoma Valley Bagel
- 6 Southwest Grill
- 7 Starbucks Coffee

### Retail

- 8 Subway
- 9 Toa Yuen Restaurant
- 10 Seaport
- 11 Pho Element
- 12 Jack's
- 13 Heidi's

### Financial Services

- 1 Health By Heidi
- 2 Boat Feet Shoe Repair
- 3 Liquor & Tobacco
- 4 Piazza's Fine Foods
- 5 Rite Aid Pharmacy
- 6 The UPS Store

- 1 Bank of America
- 2 New York Life Insurance
- 3 First American Title Insurance
- 4 Western Union

### Health & Beauty

- 1 Belbien Skin Care & Day Spa
- 2 Bella Nails
- 3 Curves
- 4 Gymboree Play & Music
- 5 V.I.P. Hair Salon
- 6 Shear Design
- 7 24 Hour Fitness

### Other Services

- 1 Shell Station
- 2 Perfit Alterations
- 3 Holiday Cleaners
- 4 Dr. Benjamin Na
- 5 VCA Animal Hospital
- 6 Our Art Room
- 7 All Stars Martial Arts



## Hillsdale Caltrain Shuttle

A free Caltrain shuttle runs between the Hillsdale Caltrain Station and the Peninsula Heights/Campus Drive Monday through Friday.

### MORNING DEPARTING SCHEDULE (AM)

HILLSDALE CALTRAIN	7:00	7:40	8:30	9:05
2121 El Camino Real	7:07	7:47	8:37	9:12
330 W. 20th	7:09	7:49	8:39	9:14
Alameda de las Pulgas	7:10	7:50	8:40	9:15
Laurelwood Shopping Ctr	7:16	7:56	8:46	9:21
UPPER PENINSULA HEIGHTS	7:17	7:57	8:47	9:22
LOWER PENINSULA HEIGHTS	7:19	7:59	8:49	9:24

### AFTERNOON DEPARTING SCHEDULE (PM)

HILLSDALE CALTRAIN	3:44	4:36	5:20	6:00	
UPPER PENINSULA HEIGHTS	3:14	4:16	4:50	5:40	6:18
LOWER PENINSULA HEIGHTS	3:16	4:18	4:52	5:42	6:20
Laurelwood Shopping Ctr	3:17	4:19	4:53	5:43	6:21
Alameda de las Pulgas	3:23	4:25	4:59	5:49	6:27
330 W. 20th	3:24	4:26	5:00	5:50	6:28
2121 El Camino Real	3:26	4:28	5:02	5:52	6:30

